

MESSANSCHLÜSSE PRESSURE GAUGE CONNECTORS

MESSANSCHLÜSSE	TEST POINT PRESSURE GAUGE CONNECTORS	14.3
GERADE MESSVERSCHRAUBUNGEN - GMV	STRAIGHT TEST POINT PRESSURE GAUGE FITTINGS - GMV	14.4
MESSANSCHLÜSSE - VKA - DKO	TEST POINT PRESSURE GAUGE CONNECTORS - VKA - DKO	14.5
HOCHDRUCK-MESS-SCHLÄUCHE - SMS	HIGH PRESSURE TEST HOSES - SMS	14.6
MANOMETER-DIREKTANSCHLÜSSE - SMD	DIRECT GAUGE ADAPTORS - SMD	14.7
MANOMETER-MESSANSCHLÜSSE - SMA	GAUGE TEST ADAPTORS - SMA	14.7

MESSANSCHLÜSSE



TEST POINT PRESSURE GAUGE CONNECTORS

mit Schraubkupplung M 16 x 2
O-Ring - Viton

with connection M 16 x 2
O-ring - Viton

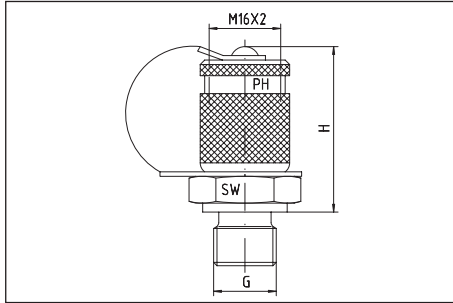

Druck Pressure PN	Gewinde Thread G	ca. Ma1e approx. dimensions		Abdichtung Sealing	Bestellzeichen Order-Code
		H	SW		
630	M 8 x 1	37	17	O-Ring Form A / O-ring form A	MAS-M 8x1-OR
630	M 10 x 1	37	17	O-Ring Form A / O-ring form A	MAS-M 10x1-OR
630	M 10 x 1	37	17	Weichdichtung Form C / Soft seal form C	MAS-M 10x1-WD
630	M 12 x 1,5	37	17	Weichdichtung Form C / Soft seal form C	MAS-M 12x1,5-WD
630	M 14 x 1,5	37	19	Weichdichtung Form C / Soft seal form C	MAS-M 14x1,5-WD
630	G 1/8"	37	17	Weichdichtung Form C / Soft seal form C	MAS-G 1/8"-WD
630	G 1/4"	37	19	Weichdichtung Form C / Soft seal form C	MAS-G 1/4"-WD
630	G 3/8"	40	22	Weichdichtung Form C / Soft seal form C	MAS-G 3/8"-WD
630	G 1/2"	40	27	Weichdichtung Form C / Soft seal form C	MAS-G 1/2"-WD
630	R 1/8" keg	36	17	Gewinde Form D / Thread form D	MAS-R 1/8"-k
630	R 1/4" keg	36	17	Gewinde Form D / Thread form D	MAS-R 1/4"-k
630	1/8" NPT	36	17	Gewinde Form D / Thread form D	MAS-1/8"-NPT
630	1/4" NPT	37	17	Gewinde Form D / Thread form D	MAS-1/4"-NPT
630	3/8" NPT	40	19	Gewinde Form D / Thread form D	MAS-3/8"-NPT
630	1/2" NPT	40	24	Gewinde Form D / Thread form D	MAS-1/2"-NPT

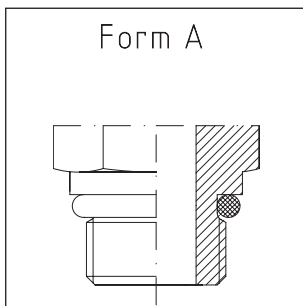

Abdichtung durch Runddichtung
(O-Ring) - SAE J 514
Sealing by O-ring in thread
undercut - SAE J 514

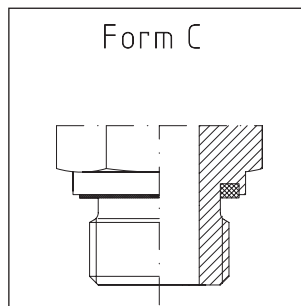

WD = Abdichtung durch
gekammerte Profildichtung
- Viton
WD = Sealing by an elastomer
captive profiled ring - Viton

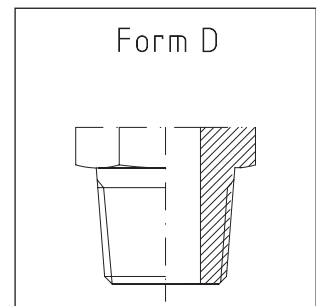

Abdichtung kegelig oder NPT
Sealing by taper or NPT

GERADE MESSVERSCHRAUBUNGEN



STRAIGHT TEST POINT PRESSURE GAUGE FITTINGS

mit Schraubkupplung M 16 x 2
O-Ring - Viton
Lieferung komplett mit Mutter und Schneidring

with connection M 16 x 2
O-ring - Viton
Delivery complete with nut and cutting ring

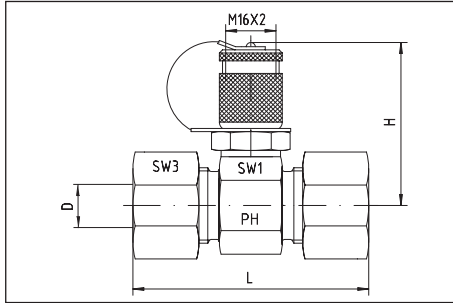

Reihe Series	Druck Pressure PN	Rohr A.D. Tube O.D. D	ca. Maße approx. dimensions				Bestellzeichen Order-Code
			L	H	SW1	SW3	
L	315	6	50,5	49,5	24	14	GMV-L-06
L	315	8	50,5	49,5	24	17	GMV-L-08
L	315	10	52,5	49,5	24	19	GMV-L-10
L	315	12	52,5	49,5	24	22	GMV-L-12
L	315	15	54,5	52,5	30	27	GMV-L-15
L	315	18	56,5	53,5	32	32	GMV-L-18
L	160	22	60,5	55,5	36	36	GMV-L-22
L	160	28	60,5	58,0	41	41	GMV-L-28
L	160	35	68,5	60,5	46	50	GMV-L-35
L	160	42	70,5	65,0	55	60	GMV-L-42
S	630	6	54,5	49,5	24	17	GMV-S-06
S	630	8	54,5	49,5	24	19	GMV-S-08
S	630	10	56,5	49,5	24	22	GMV-S-10
S	630	12	56,5	49,5	24	24	GMV-S-12
S	630	14	62,5	51,0	27	27	GMV-S-14
S	400	16	62,5	52,5	30	30	GMV-S-16
S	400	20	68,5	55,5	36	36	GMV-S-20
S	400	25	74,5	58,0	41	46	GMV-S-25
S	400	30	80,5	60,5	46	50	GMV-S-30
S	315	38	91,0	65,0	55	60	GMV-S-38

MESSANSCHLÜSSE



TEST POINT PRESSURE GAUGE CONNECTORS

mit Schraubkupplung M 16 x 2
Anschluss mit Dichtkegel und O-Ring - Viton
passend in Bohrungsform W DIN 3861
mit 24°-Konus

with connection M 16 x 2
connection with taper and O-ring - Viton
for portform W DIN 3861
with 24°-cone

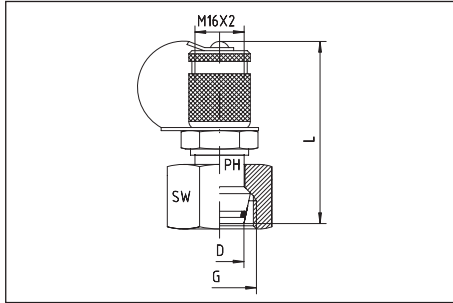

Reihe Series	Druck Pressure PN	Rohr A.D. Tube O.D. D	Gewinde Thread G	ca. Maße approx. dimensions		Bestellzeichen Order-Code
				L	SW	
L	315	6	M 12 x 1,5	72	14	VKA-DKOL-06
L	315	8	M 14 x 1,5	58	17	VKA-DKOL-08
L	315	10	M 16 x 1,5	58	19	VKA-DKOL-10
L	315	12	M 18 x 1,5	54	22	VKA-DKOL-12
L	315	15	M 22 x 1,5	57	27	VKA-DKOL-15
L	315	18	M 26 x 1,5	59	32	VKA-DKOL-18
L	160	22	M 30 x 2	60	36	VKA-DKOL-22
L	160	28	M 36 x 2	65	41	VKA-DKOL-28
L	160	35	M 45 x 2	70	50	VKA-DKOL-35
L	160	42	M 52 x 2	71	60	VKA-DKOL-42
S	630	6	M 14 x 1,5	72	17	VKA-DKOS-06
S	630	8	M 16 x 1,5	58	19	VKA-DKOS-08
S	630	10	M 18 x 1,5	58	22	VKA-DKOS-10
S	630	12	M 20 x 1,5	54	24	VKA-DKOS-12
S	630	14	M 22 x 1,5	70	27	VKA-DKOS-14
S	400	16	M 24 x 1,5	55	30	VKA-DKOS-16
S	400	20	M 30 x 2	64	36	VKA-DKOS-20
S	400	25	M 36 x 2	66	46	VKA-DKOS-25
S	400	30	M 42 x 2	70	50	VKA-DKOS-30
S	315	38	M 52 x 2	72	60	VKA-DKOS-38

HOCHDRUCK-MESS- SCHLÄUCHE



HIGH PRESSURE TEST HOSES

mit Schraubkupplung M 16 x 2

with metric swivel end M 16 x 2

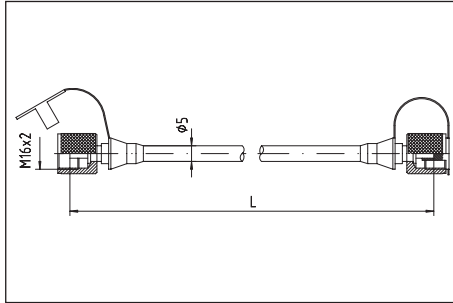

Druck Pressure PN	Schlauch / DN Hose / Bore DN	Gewinde Thread	Länge Length L	Bestellzeichen Order-Code
630	02	M 16 x 2	200	SMS-M 16-200
630	02	M 16 x 2	400	SMS-M 16-400
630	02	M 16 x 2	630	SMS-M 16-630
630	02	M 16 x 2	800	SMS-M 16-800
630	02	M 16 x 2	1000	SMS-M 16-1000
630	02	M 16 x 2	1500	SMS-M 16-1500
630	02	M 16 x 2	2000	SMS-M 16-2000
630	02	M 16 x 2	2500	SMS-M 16-2500
630	02	M 16 x 2	3200	SMS-M 16-3200
630	02	M 16 x 2	4000	SMS-M 16-4000

MANOMETER-MESS-ANSCHLÜSSE



GAUGE TEST ADAPTORS

Innengewinde starr: BSP + NPT
 Außengewinde: M 16 x 2
 Dichtung: Viton

Female thread: BSP + NPT
 Male thread: M 16 x 2
 Sealing: Viton

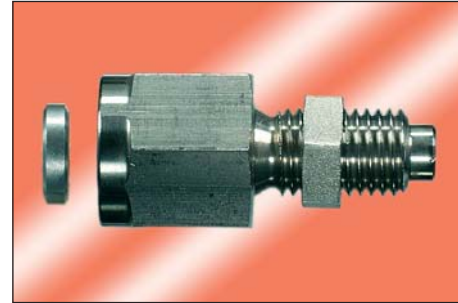
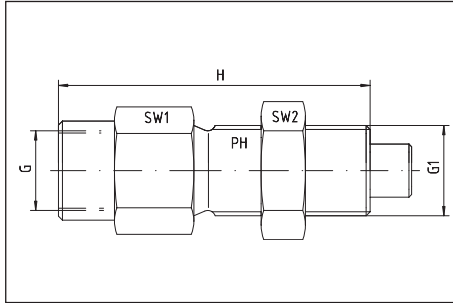

Druck Pressure PN	Gewinde Thread		ca. Maße approx. dimensions			Bestellzeichen Order-Code
	G	G1	H	SW1	SW2	
630	1/4" BSP	M 16 x 2	50	19	19	SMA 20-R 1/4"-V
630	1/2" BSP	M 16 x 2	60	27	19	SMA 20-R 1/2"-V
630	1/4" NPT	M 16 x 2	50	19	19	SMA 20-1/4"NPT-V
630	1/2" NPT	M 16 x 2	60	27	19	SMA 20-1/2"NPT-V

MANOMETER-DIREKT-ANSCHLÜSSE

DIRECT GAUGE ADAPTORS

Innengewinde starr: BSP + NPT
 Muttergewinde drehbar: M 16 x 2

Female thread: BSP + NPT
 Nut female swivel: M 16 x 2

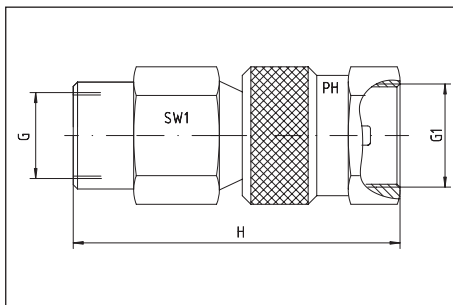

Druck Pressure PN	Gewinde Thread		ca. Maße approx. dimensions		Bestellzeichen Order-Code
	G	G1	H	SW1	
630	1/4" BSP	M 16 x 2	41	19	SMD 20-R 1/4"
630	1/2" BSP	M 16 x 2	51	27	SMD 20-R 1/2"
630	1/4" NPT	M 16 x 2	41	19	SMD 20-1/4"NPT
630	1/2" NPT	M 16 x 2	51	27	SMD 20-1/2"NPT