

## 3-way low pressure lever operated ball valve

BOOK INDEX

SECTION INDEX

BSP female thread to ISO 228

L bore, material AISI 316

Ball and stem seal PTFE  
(-20°C to +180°C)

When operating at higher temperatures, please refer to below pressure diagram.

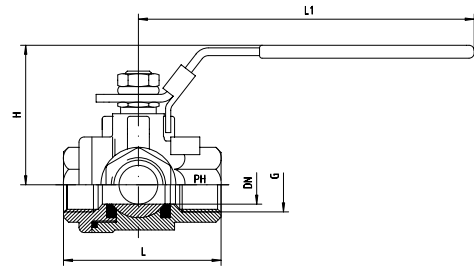

Size	DN	Pressure PB	Approx. Dimensions				Part code
			G	H	L	L1	
1/4"	11.2	63	1/4"	50	68	97	KH-G 1/4"-3-W-L
3/8"	11.2	63	3/8"	50	68	97	KH-G 3/8"-3-W-L
1/2"	12.7	63	1/2"	50	68	97	KH-G 1/2"-3-W-L
3/4"	16.0	63	3/4"	64	83	127	KH-G 3/4"-3-W-L
1"	20.0	63	1"	66	90	127	KH-G 1"-3-W-L
1 1/4"	25.0	63	1 1/4"	80	97	145	KH-G 1 1/4"-3-W-L
1 1/2"	32.0	63	1 1/2"	83	114	145	KH-G 1 1/2"-3-W-L
2"	38.1	63	2"	96	142	205	KH-G 2"-3-W-L

