

BSP to BSP taper male male

BOOK INDEX

SECTION INDEX

BSP parallel 60° coned male to BSP taper male
ISO 8434-6 / BS 5200

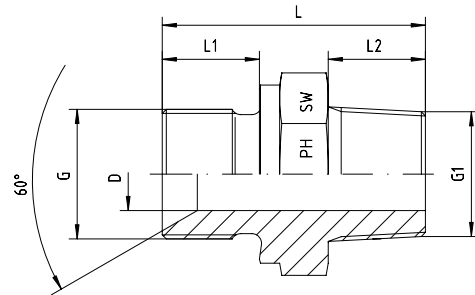

5

Pressure PN	Thread		Approx. Dimensions					Part code	
	G = BSP	G1 = BSPT	L	L1	L2	D	SW		
400	1/8"-28	1/8"-28	23.0	8	8	4.0	14		1050710-02-02
400	1/4"-19	1/4"-19	30.0	10	12	6.0	19		1050710-04-04
400	3/8"-19	3/8"-19	32.5	12	12	9.0	22		1050710-06-06
400	1/2"-14	1/2"-14	37.0	14	14	12.5	27		1050710-08-08
400	3/4"-14	3/4"-14	47.0	16	19	17.5	32		1050710-12-12
400	1"-11	1"-11	49.0	18	18	22.0	41		1050710-16-16
200	1 1/4"-11	1 1/4"-11	54.5	20	20	29.0	50		1050710-20-20
200	1 1/2"-11	1 1/2"-11	58.5	22	22	37.0	55		1050710-24-24
100	2"-11	2"-11	66.0	25	26	45.0	70		1050710-32-32

Pressure PN	Thread		Approx. Dimensions					Part code	
	G = BSP	G1 = BSPT	L	L1	L2	D	SW		
400	1/4"-19	1/8"-28	26.0	10	8	4.0	19		1050710-04-02
400	1/4"-19	3/8"-19	32.0	10	12	7.0	19		1050710-04-06
400	1/4"-19	1/2"-14	34.0	10	14	6.0	22		1050710-04-08
400	3/8"-19	1/4"-19	33.0	12	12	7.0	22		1050710-06-04
400	3/8"-19	1/2"-14	42.0	12	19	9.0	22		1050710-06-08
400	1/2"-14	3/8"-19	37.0	14	12	9.0	27		1050710-08-06
400	1/2"-14	3/4"-14	45.0	14	19	12.5	27		1050710-08-12
400	3/4"-14	1/2"-14	40.0	16	14	12.5	32		1050710-12-08
400	3/4"-14	1"-11	45.0	16	18	17.5	36		1050710-12-16