

BSP taper to NPT male male

BOOK INDEX

SECTION INDEX

BSP parallel 60° coned male to NPT male.

BSP parallel male with form B sealing shoulder.

ISO 8434-6 / BS 5200

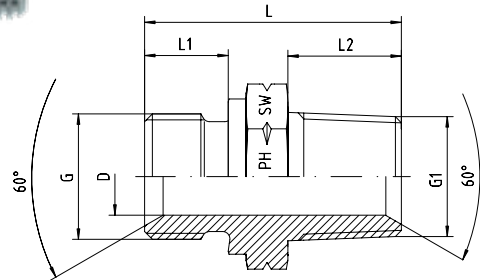

5

Pressure PN	Thread		Approx. Dimensions					SW	Part code BSP x NPT
	G = BSP	G1 = NPT	L	L1	L2	D			
400	1/8"-28	1/8"-27	24.5	8	10.0	4.0	14	1052810-02-02	
400	1/4"-19	1/4"-18	32.5	10	15.0	6.0	19	1052810-04-04	
400	3/8"-19	3/8"-18	38.0	12	15.3	9.0	22	1052810-06-06	
400	1/2"-14	1/2"-14	43.0	14	20.0	12.5	27	1052810-08-08	
400	3/4"-14	3/4"-14	47.0	16	20.0	17.5	32	1052810-12-12	
400	1"-11	1"-11.5	54.5	18	25.0	22.5	41	1052810-16-16	
200	1 1/4"-11	1 1/4"-11.5	66.0	20	25.5	30.0	50	1052810-20-20	
200	1 1/2"-11	1 1/2"-11.5	64.0	22	26.0	37.0	55	1052810-24-24	
100	2"-11	2"-11.5	66.0	25	26.0	45.0	70	1052810-32-32	

Pressure PN	Thread		Approx. Dimensions					SW	Part code BSP x NPT
	G = BSP	G1 = NPT	L	L1	L2	D			
400	1/8"-28	1/4"-18	30.0	8	15.0	4.0	14	1052810-02-04	
400	1/4"-19	1/8"-27	27.5	10	10.0	4.0	19	1052810-04-02	
400	1/4"-19	3/8"-18	33.0	10	15.3	6.0	19	1052810-04-06	
400	1/4"-19	1/2"-14	40.0	10	20.0	6.0	22	1052810-04-08	
400	3/8"-19	1/4"-18	35.5	12	15.0	7.0	22	1052810-06-04	
400	3/8"-19	1/2"-14	42.0	12	20.0	9.0	22	1052810-06-08	
400	3/8"-19	3/4"-14	42.0	12	20.0	9.0	27	1052810-06-12	
400	1/2"-14	1/4"-18	40.0	14	15.0	7.0	27	1052810-08-04	
400	1/2"-14	3/8"-18	40.0	14	15.3	9.0	27	1052810-08-06	
400	1/2"-14	3/4"-14	45.0	14	20.0	12.0	27	1052810-08-12	
400	3/4"-14	1/2"-14	45.0	16	20.0	12.5	32	1052810-12-08	
400	3/4"-14	1"-11.5	52.0	16	25.0	17.5	36	1052810-12-16	
400	1"-11	3/8"-18	45.0	18	15.3	9.0	41	1052810-16-06	
400	1"-11	1/2"-14	50.0	18	20.0	12.5	41	1052810-16-08	
400	1"-11	3/4"-14	50.0	18	20.0	15.0	41	1052810-16-12	