

## BSP swivel female to BSP taper male

BOOK INDEX

SECTION INDEX

**BSP parallel 60° coned swivel female to BSP taper male**

ISO 8434-6 / BS 5200

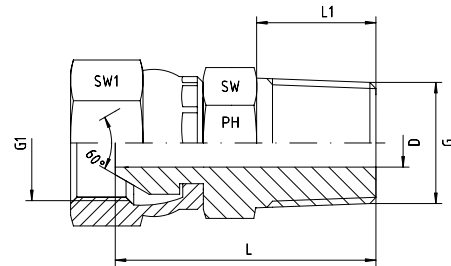

5

Pressure PN	Thread		Approx. Dimensions					Part code	
	G1 = BSP	G = BSPT	L	L1	D	SW	SW1		
400	1/8"-28	1/8"-28	23.0	8	4.0	12	14		2070511-02-02
400	1/4"-19	1/4"-19	28.0	12	5.0	14	19		2070511-04-04
400	3/8"-19	3/8"-19	30.6	12	8.0	19	22		2070511-06-06
400	1/2"-14	1/2"-14	37.0	14	9.5	24	27		2070511-08-08
400	3/4"-14	3/4"-14	39.0	16	16.5	27	32		2070511-12-12
400	1"-11	1"-11	44.3	18	22.5	36	41		2070511-16-16
200	1 1/4"-11	1 1/4"-11	51.9	20	29.0	46	50		2070511-20-20
200	1 1/2"-11	1 1/2"-11	54.6	22	33.5	50	55		2070511-24-24
100	2"-11	2"-11	69.0	26	42.0	65	70		2070511-32-32