

## BSP male - swivel female 90° elbow

BOOK INDEX

SECTION INDEX

**BSP parallel 60° coned male to BSP parallel 60° coned swivel female 90° elbow**

Short-radius / "block"

ISO 8434-6 / BS 5200

**Please note** - the male threads do not have a form B sealing shoulder or any shoulder to accept a bonded seal!

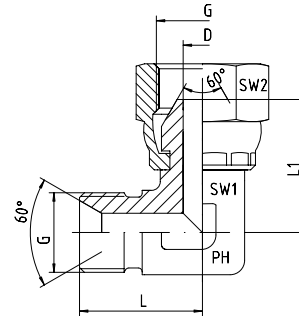

5

Pressure PN	Thread G	Approx. Dimensions					Part code
		L	L1	D	SW1	SW2	
400	1/8"-28	20.0	18.0	4.0	12	14	1560510-02
400	1/4"-19	24.5	23.5	6.0	14	19	1560510-04
400	3/8"-19	25.5	25.5	8.0	17	22	1560510-06
400	1/2"-14	29.5	29.5	11.0	19	27	1560510-08
400	3/4"-14	37.0	37.0	16.0	27	32	1560510-12
400	1"-11	43.0	43.0	22.0	36	41	1560510-16
200	1 1/4"-11	51.0	51.0	28.0	41	50	1560510-20
200	1 1/2"-11	59.0	50.0	33.5	50	55	1560510-24
100	2"-11	77.5	80.0	42.0	65	70	1560510-32