

## BSPP hexagonal reducing socket

BOOK INDEX

SECTION INDEX

**BSP parallel fixed female reducing socket**

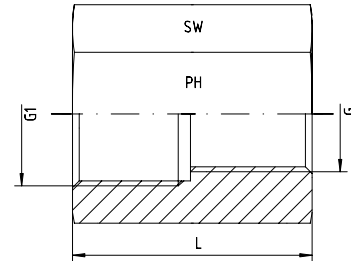

5

| Pressure<br>PN | Thread<br>G1 x G | Approx. Dimensions |    | Part code     |
|----------------|------------------|--------------------|----|---------------|
|                |                  | L                  | SW |               |
| 630            | 1/4" x 1/8"      | 25                 | 17 | 1050512-04-02 |
| 630            | 3/8" x 1/4"      | 32                 | 22 | 1050512-06-04 |
| 400            | 1/2" x 3/8"      | 35                 | 27 | 1050512-08-06 |
| 400            | 1/2" x 1/4"      | 35                 | 27 | 1050512-08-04 |
| 400            | 3/4" x 1/2"      | 38                 | 32 | 1050512-12-08 |
| 400            | 3/4" x 3/8"      | 38                 | 32 | 1050512-12-06 |
| 400            | 1" x 3/4"        | 42                 | 41 | 1050512-16-12 |
| 400            | 1" x 1/2"        | 42                 | 41 | 1050512-16-08 |
| 315            | 1 1/4" x 1"      | 48                 | 50 | 1050512-20-16 |
| 315            | 1 1/2" x 1 1/4"  | 48                 | 55 | 1050512-24-20 |
| 250            | 2" x 1 1/2"      | 56                 | 70 | 1050512-32-24 |