

## BSP hexagonal head plug

BOOK INDEX

SECTION INDEX

### BSP parallel 60° coned male plug.

Form B sealing shoulder.

ISO 8434-6 / BS 5200

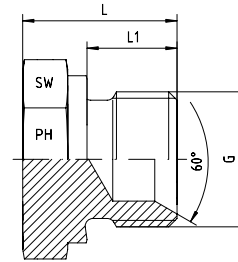

5

Pressure PN	Thread G = BSP	Approx. Dimensions			Part code
		L	L1	SW	
400	1/8"-28	14.0	8	14	1050514-02
400	1/4"-19	17.0	10	19	1050514-04
400	3/8"-19	20.5	12	22	1050514-06
400	1/2"-14	24.0	14	27	1050514-08
400	5/8"-14	24.0	14	30	1050514-10
400	3/4"-14	27.0	16	32	1050514-12
400	1"-11	31.0	18	41	1050514-16
200	1 1/4"-11	33.0	20	50	1050514-20
200	1 1/2"-11	36.0	22	55	1050514-24
100	2"-11	36.0	22	70	1050514-32