

Straight reducing coupling

BOOK INDEX

SECTION INDEX

to ISO 8434-1 / DIN 2353

LL and L series

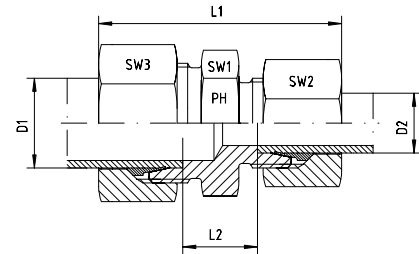

Series	Pressure PN	Tube O.D.		Approx. Dimensions					Part code
		D1	D2	L1	L2	SW1	SW2	SW3	
LL	100	6	4	36.0	10.5	11	10	12	GRV-LL-06/04
LL	100	8	6	38.0	11.0	12	12	14	GRV-LL-08/06

Series	Pressure PN	Tube O.D.		Approx. Dimensions					Part code
		D1	D2	L1	L2	SW1	SW2	SW3	
L	500	8	6	45.5	11.0	14	14	17	GRV-L-08/06
L	500	10	6	47.0	12.0	17	14	19	GRV-L-10/06
L	500	10	8	47.0	12.0	17	17	19	GRV-L-10/08
L	400	12	6	48.0	13.0	19	14	22	GRV-L-12/06
L	400	12	8	48.0	13.0	19	17	22	GRV-L-12/08
L	400	12	10	49.5	14.0	19	19	22	GRV-L-12/10
L	400	15	6	50.5	14.0	24	14	27	GRV-L-15/06
L	400	15	8	50.5	14.0	24	17	27	GRV-L-15/08
L	400	15	10	52.0	15.0	24	19	27	GRV-L-15/10
L	400	15	12	52.0	15.0	24	22	27	GRV-L-15/12
L	400	18	8	52.0	14.5	27	27	32	GRV-L-18/08
L	400	18	10	53.5	15.5	27	19	32	GRV-L-18/10
L	400	18	12	53.5	15.5	27	22	32	GRV-L-18/12
L	400	18	15	56.5	16.5	27	27	32	GRV-L-18/15
L	250	22	8	56.5	17.5	32	17	36	GRV-L-22/08
L	250	22	10	57.0	17.5	32	19	36	GRV-L-22/10
L	250	22	12	57.0	17.5	32	22	36	GRV-L-22/12
L	250	22	15	59.0	18.5	32	27	36	GRV-L-22/15
L	250	22	18	60.0	18.0	32	32	36	GRV-L-22/18
L	250	28	10	60.0	20.5	41	19	41	GRV-L-28/10
L	250	28	12	60.0	19.0	41	22	41	GRV-L-28/12
L	250	28	15	62.5	19.0	41	27	41	GRV-L-28/15
L	250	28	18	61.0	19.0	41	32	41	GRV-L-28/18
L	250	28	22	64.0	21.0	41	36	41	GRV-L-28/22
L	250	35	15			46	27	50	GRV-L-35/15
L	250	35	18	66.5	19.0	46	32	50	GRV-L-35/18
L	250	35	22	69.5	21.0	46	36	50	GRV-L-35/22
L	250	35	28	70.5	21.0	46	41	50	GRV-L-35/28
L	250	42	15	64.0	21.0	55	27	60	GRV-L-42/15
L	250	42	18		20.5	55	32	60	GRV-L-42/18
L	250	42	22	70.5	22.5	55	36	60	GRV-L-42/22
L	250	42	28	71.0	22.5	55	41	60	GRV-L-42/28
L	250	42	35	75.0	21.5	55	50	60	GRV-L-42/35

Fittings can be supplied with nuts with silver-plated threads to help to prevent galling, or can be supplied body only - no nut or cutting ring.

If you require silver-plated nuts, use suffix -SC. If you require body only, use suffix -OMD.

Eg. GRV-L-12/10-SC or, GRV-L-12/10-OMD.