

Straight reducing coupling

BOOK INDEX

SECTION INDEX

to ISO 8434-1 / DIN 2353

S series

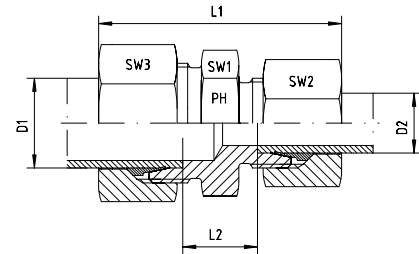

| Series | Pressure PN | Tube O.D. | | Approx. Dimensions | | | | | Part code |
|--------|----------------|-----------|----|--------------------|------|-----|-----|-----|-------------|
| | | D1 | D2 | L1 | L2 | SW1 | SW2 | SW3 | |
| S | 800 | 8 | 6 | 52.5 | 18.0 | 17 | 17 | 19 | GRV-S-08/06 |
| S | 800 | 10 | 6 | 53.5 | 17.5 | 19 | 17 | 22 | GRV-S-10/06 |
| S | 800 | 10 | 8 | 54.0 | 17.5 | 19 | 19 | 22 | GRV-S-10/08 |
| S | 630 | 12 | 6 | 55.5 | 19.5 | 22 | 17 | 24 | GRV-S-12/06 |
| S | 630 | 12 | 8 | 55.5 | 19.5 | 22 | 19 | 24 | GRV-S-12/08 |
| S | 630 | 12 | 10 | 56.5 | 19.0 | 22 | 22 | 24 | GRV-S-12/10 |
| S | 630 | 14 | 6 | | | 24 | 17 | 27 | GRV-S-14/06 |
| S | 630 | 14 | 8 | | | 24 | 19 | 27 | GRV-S-14/08 |
| S | 630 | 14 | 10 | 60.0 | 20.5 | 24 | 22 | 27 | GRV-S-14/10 |
| S | 630 | 14 | 12 | 60.0 | 20.5 | 24 | 24 | 27 | GRV-S-14/12 |
| S | 630 | 16 | 6 | 59.5 | 20.0 | 27 | 17 | 30 | GRV-S-16/06 |
| S | 630 | 16 | 8 | 59.5 | 20.0 | 27 | 19 | 30 | GRV-S-16/08 |
| S | 630 | 16 | 10 | 60.5 | 20.0 | 27 | 22 | 30 | GRV-S-16/10 |
| S | 630 | 16 | 12 | 60.5 | 20.0 | 27 | 24 | 30 | GRV-S-16/12 |
| S | 630 | 16 | 14 | 63.5 | 21.5 | 27 | 27 | 30 | GRV-S-16/14 |
| S | 420 | 20 | 6 | 64.5 | 23.5 | 32 | 17 | 36 | GRV-S-20/06 |
| S | 420 | 20 | 8 | 64.5 | 21.0 | 32 | 19 | 36 | GRV-S-20/08 |
| S | 420 | 20 | 10 | 65.5 | 22.0 | 32 | 22 | 36 | GRV-S-20/10 |
| S | 420 | 20 | 12 | 65.5 | 22.0 | 32 | 24 | 36 | GRV-S-20/12 |
| S | 420 | 20 | 14 | 68.5 | 23.0 | 32 | 27 | 36 | GRV-S-20/14 |
| S | 420 | 20 | 16 | 69.5 | 23.0 | 32 | 30 | 36 | GRV-S-20/16 |
| S | 420 | 25 | 6 | | | 41 | 17 | 46 | GRV-S-25/06 |
| S | 420 | 25 | 8 | 71.5 | 26.5 | 41 | 19 | 46 | GRV-S-25/08 |
| S | 420 | 25 | 10 | 72.5 | 27.5 | 41 | 22 | 46 | GRV-S-25/10 |
| S | 420 | 25 | 12 | 72.5 | 24.0 | 41 | 24 | 46 | GRV-S-25/12 |
| S | 420 | 25 | 14 | 74.5 | 26.5 | 41 | 27 | 46 | GRV-S-25/14 |
| S | 420 | 25 | 16 | 74.5 | 25.5 | 41 | 30 | 46 | GRV-S-25/16 |
| S | 420 | 25 | 20 | 79.0 | 25.5 | 41 | 36 | 46 | GRV-S-25/20 |
| S | 420 | 30 | 10 | 74.5 | 25.0 | 46 | 22 | 50 | GRV-S-30/10 |
| S | 420 | 30 | 12 | 74.5 | 27.0 | 46 | 24 | 50 | GRV-S-30/12 |
| S | 420 | 30 | 14 | | | 46 | 27 | 50 | GRV-S-30/14 |
| S | 420 | 30 | 16 | 78.5 | 26.0 | 46 | 30 | 50 | GRV-S-30/16 |
| S | 420 | 30 | 20 | 81.5 | 26.0 | 46 | 36 | 50 | GRV-S-30/20 |
| S | 420 | 30 | 25 | 86.0 | 26.5 | 46 | 46 | 50 | GRV-S-30/25 |
| S | 420 | 38 | 10 | 75.5 | 24.5 | 55 | 22 | 60 | GRV-S-38/10 |
| S | 420 | 38 | 12 | | | 55 | 24 | 60 | GRV-S-38/12 |
| S | 420 | 38 | 14 | | | 55 | 27 | 60 | GRV-S-38/14 |
| S | 420 | 38 | 16 | 85.0 | 26.0 | 55 | 30 | 60 | GRV-S-38/16 |
| S | 420 | 38 | 20 | 88.0 | 28.0 | 55 | 36 | 60 | GRV-S-38/20 |
| S | 420 | 38 | 25 | 94.0 | 29.0 | 55 | 46 | 60 | GRV-S-38/25 |
| S | 420 | 38 | 30 | 95.5 | 29.5 | 55 | 50 | 60 | GRV-S-38/30 |

Fittings can be supplied with nuts with silver-plated threads to help to prevent galling, or can be supplied body only - no nut or cutting ring.

If you require silver-plated nuts, use suffix -SC. If you require body only, use suffix -OMD.

Eg. GRV-S-12/10-SC or, GRV-S-12/10-OMD.