

Equal cross

BOOK INDEX

SECTION INDEX

to ISO 8434-1 / DIN 2353

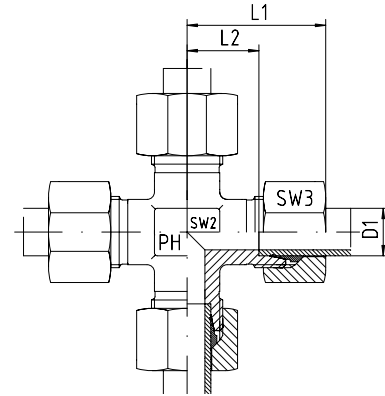

Series	Pressure PN	Tube O.D. D1	Approx. Dimensions				Part code
			L1	L2	SW2	SW3	
LL	100	4	21	11.0	7	10	KV-LL-04
LL	100	6	21	9.5	9	12	KV-LL-06
LL	100	8	23	11.5	12	14	KV-LL-08

Series	Pressure PN	Tube O.D. D1	Approx. Dimensions				Part code
			L1	L2	SW2	SW3	
L	315	6	27	12.0	12	14	KV-L-06
L	315	8	29	14.0	12	17	KV-L-08
L	315	10	30	15.0	14	19	KV-L-10
L	315	12	32	17.0	17	22	KV-L-12
L	315	15	36	21.0	19	27	KV-L-15
L	315	18	40	23.5	24	32	KV-L-18
L	160	22	44	27.5	27	36	KV-L-22
L	160	28	47	30.5	36	41	KV-L-28
L	160	35	56	34.5	41	50	KV-L-35
L	160	42	63	40.0	50	60	KV-L-42

Series	Pressure PN	Tube O.D. D1	Approx. Dimensions				Part code
			L1	L2	SW2	SW3	
S	630	6	31	16.0	12	17	KV-S-06
S	630	8	32	17.0	14	19	KV-S-08
S	630	10	34	17.5	17	22	KV-S-10
S	630	12	38	21.5	17	24	KV-S-12
S	630	14	40	22.0	19	27	KV-S-14
S	400	16	43	24.5	24	30	KV-S-16
S	400	20	48	26.5	27	36	KV-S-20
S	400	25	54	30.0	36	46	KV-S-25
S	400	30	62	35.5	41	50	KV-S-30
S	315	38	72	41.0	50	60	KV-S-38

Fittings can be supplied with nuts with silver-plated threads to help to prevent galling, or can be supplied body only - no nut or cutting ring.

If you require silver-plated nuts, use suffix -SC. If you require body only, use suffix -OMD.

Eg. KV-L-12-SC, or KV-L-12-OMD.