



24° compression fittings to ISO 8434-1 / DIN 2353

Male stud coupling to UNF

BOOK INDEX

SECTION INDEX

to ISO 8434-1 / DIN 2353

L series

UNF thread to ASA B 1.1-1960 / J514

Note - correct port dimensions must be created.

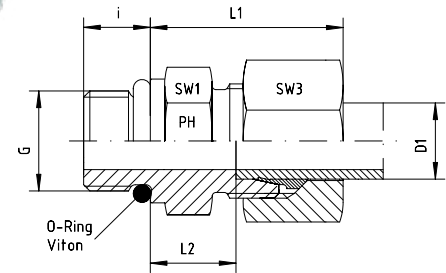

Series	Pressure PN	Tube O.D. D1	Thread G	Approx. Dimensions					O-ring	Part code
				L1	L2	i	SW1	SW3		
L	315	6	7/16"-20 UNF	23.5	9.0	9.2	17	14	8.92 x 1.83	GE-L-06-7/16"-UNF
L	315	6	1/2"-20 UNF		10.0	9.2	17	14	10.52 x 1.83	GE-L-06-1/2"-UNF
L	315	6	9/16"-18 UNF			10.0	19	14	11.90 x 1.98	GE-L-06-9/16"-UNF
L	315	8	7/16"-20 UNF	25.0	10.0	9.2	17	17	8.92 x 1.83	GE-L-08-7/16"-UNF
L	315	8	1/2"-20 UNF	25.0	10.0	9.2	17	17	10.52 x 1.83	GE-L-08-1/2"-UNF
L	315	8	9/16"-18 UNF	25.0	10.0	10.0	19	17	11.90 x 1.98	GE-L-08-9/16"-UNF
L	315	10	7/16"-20 UNF	26.0	11.0	9.2	17	19	8.92 x 1.83	GE-L-10-7/16"-UNF
L	315	10	1/2"-20 UNF	26.0	11.0	9.2	17	19	10.52 x 1.83	GE-L-10-1/2"-UNF
L	315	10	9/16"-18 UNF	26.0	11.0	10.0	19	19	11.90 x 1.98	GE-L-10-9/16"-UNF
L	315	10	3/4"-16 UNF	30.5	13.0	11.2	24	19	16.36 x 2.20	GE-L-10-3/4"-UNF
L	315	12	9/16"-18 UNF	26.0	12.5	10.0	19	22	11.90 x 1.98	GE-L-12-9/16"-UNF
L	315	12	3/4"-16 UNF	27.0	12.5	11.2	24	22	16.36 x 2.20	GE-L-12-3/4"-UNF
L	315	12	7/8"-14 UNF	27.5	13.5	12.7	27	22	19.18 x 2.46	GE-L-12-7/8"-UNF
L	315	15	9/16"-18 UNF	29.0	14.0	10.0	24	27	11.90 x 1.98	GE-L-15-9/16"-UNF
L	315	15	3/4"-16 UNF	29.0	14.0	11.2	24	27	16.36 x 2.20	GE-L-15-3/4"-UNF
L	315	15	7/8"-14 UNF	29.0	14.0	12.7	27	27	19.18 x 2.46	GE-L-15-7/8"-UNF
L	315	18	3/4"-16 UNF	31.0	14.5	11.2	27	32	16.36 x 2.20	GE-L-18-3/4"-UNF
L	315	18	7/8"-14 UNF	31.0	14.5	12.7	27	32	19.18 x 2.46	GE-L-18-7/8"-UNF
L	315	18	1 1/16"-12 UNF	31.0	14.5	15.0	32	32	23.47 x 2.95	GE-L-18-1 1/16"-UNF
L	160	22	3/4"-16 UNF	33.0	16.5	11.2	32	36	16.36 x 2.20	GE-L-22-3/4"-UNF
L	160	22	7/8"-14 UNF	33.0	16.5	12.7	32	36	19.18 x 2.46	GE-L-22-7/8"-UNF
L	160	22	1 1/16"-12 UNF	33.0	16.5	15.0	32	36	23.47 x 2.95	GE-L-22-1 1/16"-UNF
L	160	22	1 5/16"-12 UNF	33.0	16.5	15.0	41	36	29.74 x 2.95	GE-L-22-1 5/16"-UNF
L	160	28	7/8"-14 UNF	34.0	17.5	12.7	41	41	19.18 x 2.46	GE-L-28-7/8"-UNF
L	160	28	1 1/16"-12 UNF	34.0	17.5	15.0	41	41	23.47 x 2.95	GE-L-28-1 1/16"-UNF
L	160	28	1 5/16"-12 UNF	34.0	17.5	15.0	41	41	29.74 x 2.95	GE-L-28-1 5/16"-UNF
L	160	28	1 5/8"-12 UNF	34.0	17.5	15.0	50	41	37.46 x 3.00	GE-L-28-1 5/8"-UNF
L	160	35	1 1/16"-12 UNF	39.0	17.5	15.0	46	50	23.47 x 2.95	GE-L-35-1 1/16"-UNF
L	160	35	1 5/16"-12 UNF	39.0	17.5	15.0	46	50	29.74 x 2.95	GE-L-35-1 5/16"-UNF
L	160	35	1 5/8"-12 UNF	39.0	17.5	15.0	50	50	37.46 x 3.00	GE-L-35-1 5/8"-UNF
L	160	42	1 5/8"-12 UNF	42.0	19.0	15.0	55	60	37.46 x 3.00	GE-L-42-1 5/8"-UNF
L	160	42	1 7/8"-12 UNF	42.0	19.0	15.0	55	60	43.69 x 3.00	GE-L-42-1 7/8"-UNF

Fittings can be supplied with nuts with silver-plated threads to help to prevent galling, or can be supplied body only - no nut or cutting ring.

If you require silver-plated nuts, use suffix -SC. If you require body only, use suffix -OMD.

Eg. GE-L-12-3/4"-UNF-SC, or GE-L-12-3/4"-UNF-OMD.