



# 24° compression fittings to ISO 8434-1 / DIN 2354

## Adjustable standpipe branch tee

BOOK INDEX

SECTION INDEX

to ISO 8434-1 / DIN 2353

L and S series

The swivel female must be finally assembled with a 1/2 turn after torque increases.

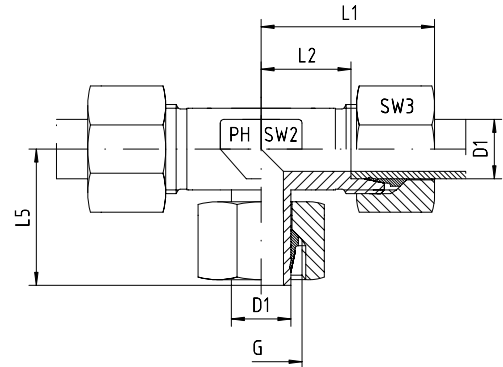

Series	Pressure PN	Tube O.D. D1	Thread G	Approx. Dimensions					Part code
				L1	L2	L5	SW2	SW3	
L	315	6	M 12 x 1.5	27	12.0	26.0	12	14	EVT-L-06
L	315	8	M 14 x 1.5	29	14.0	27.5	12	17	EVT-L-08
L	315	10	M 16 x 1.5	30	15.0	29.0	14	19	EVT-L-10
L	315	12	M 18 x 1.5	32	17.0	29.5	17	22	EVT-L-12
L	315	15	M 22 x 1.5	36	21.0	32.5	19	27	EVT-L-15
L	315	18	M 26 x 1.5	40	23.5	35.5	24	32	EVT-L-18
L	160	22	M 30 x 2	44	27.5	38.5	27	36	EVT-L-22
L	160	28	M 36 x 2	47	30.5	41.5	36	41	EVT-L-28
L	160	35	M 45 x 2	56	34.5	54.0	41	50	EVT-L-35
L	160	42	M 52 x 2	63	40.0	56.0	50	60	EVT-L-42

Series	Pressure PN	Tube O.D. D1	Thread G	Approx. Dimensions					Part code
				L1	L2	L5	SW2	SW3	
S	630	6	M 14 x 1.5	31	16.0	27.0	12	17	EVT-S-06
S	630	8	M 16 x 1.5	32	17.0	27.5	14	19	EVT-S-08
S	630	10	M 18 x 1.5	34	17.5	30.0	17	22	EVT-S-10
S	630	12	M 20 x 1.5	38	21.5	31.0	17	24	EVT-S-12
S	630	14	M 22 x 1.5	40	22.0	35.0	19	27	EVT-S-14
S	400	16	M 24 x 1.5	43	24.5	36.5	24	30	EVT-S-16
S	400	20	M 30 x 2	48	26.5	44.5	27	36	EVT-S-20
S	400	25	M 36 x 2	54	30.0	50.0	36	46	EVT-S-25
S	400	30	M 42 x 2	62	35.5	55.0	41	50	EVT-S-30
S	250	38	M 52 x 2	72	41.0	63.0	50	60	EVT-S-38

Fittings can be supplied with nuts with silver-plated threads to help to prevent galling, or can be supplied body only - no nut or cutting ring.

If you require silver-plated nuts, use suffix -SC. If you require body only, use suffix -OMD.

Eg. EVT-L-12-SC, or EVT-L-12-OMD