

Hexagonal reducing bush – BSP parallel – with captive seal

BOOK INDEX

SECTION INDEX

Form B

Both threads BSP parallel
to DIN / ISO 228

Male thread with Viton
elastomeric soft seal

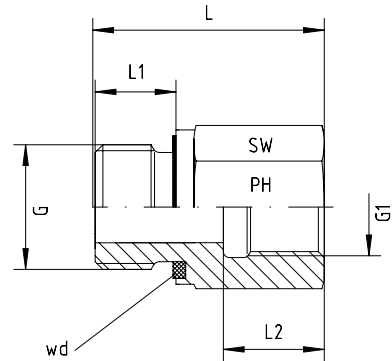
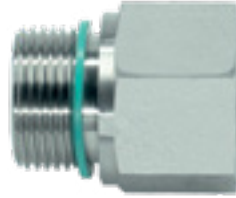

Pressure PN	Male Thread G	Female Thread G1	Approx. Dimensions				Form	Part code
			L	L1	L2	SW		
630	G 1/8"	G 3/8"	32.0	8.0	17.0	24	B	GRI-1/8"-wd x 1/2"
630	G 1/8"	G 1/4"	31.0	8.0	17.0	19	B	GRI-1/8"-wd x 3/8"
400	G 1/4"	G 1"	46.0	12.0	24.5	41	B	GRI-1/4"-wd x 1"
630	G 1/4"	G 3/4"	43.0	12.0	22.0	36	B	GRI-1/4"-wd x 3/4"
630	G 1/4"	G 1/2"	40.0	12.0	20.0	27	B	GRI-1/4"-wd x 1/2"
630	G 1/4"	G 3/8"	36.0	12.0	17.0	24	B	GRI-1/4"-wd x 3/8"
630	G 1/4"	G 1/8"	28.0	12.0	12.0	19	B	GRI-1/4"-wd x 1/8"
400	G 3/8"	G 1"	46.5	12.0	24.5	41	B	GRI-3/8"-wd x 1"
400	G 3/8"	G 3/4"	44.0	12.0	22.0	36	B	GRI-3/8"-wd x 3/4"
630	G 3/8"	G 1/2"	41.0	12.0	20.0	27	B	GRI-3/8"-wd x 1/2"
630	G 3/8"	G 1/4"	36.0	12.0	17.0	22	B	GRI-3/8"-wd x 1/4"
400	G 1/2"	G 1 1/4"	53.0	14.0	26.5	55	B	GRI-1/2"-wd x 1 1/4"
400	G 1/2"	G 1"	49.0	14.0	24.5	41	B	GRI-1/2"-wd x 1"
400	G 1/2"	G 3/4"	46.0	14.0	22.0	36	B	GRI-1/2"-wd x 3/4"
630	G 1/2"	G 3/8"	36.0	14.0	17.0	27	B	GRI-1/2"-wd x 3/8"
315	G 3/4"	G 1 1/2"	57.0	16.0	28.5	60	B	GRI-3/4"-wd x 1 1/2"
400	G 3/4"	G 1 1/4"	55.0	16.0	26.5	55	B	GRI-3/4"-wd x 1 1/4"
400	G 3/4"	G 1"	51.0	16.0	24.5	41	B	GRI-3/4"-wd x 1"
400	G 3/4"	G 1/2"	41.0	16.0	20.0	32	B	GRI-3/4"-wd x 1/2"
315	G 1"	G 1 1/2"	59.0	18.0	28.5	60	B	GRI-1"-wd x 1 1/2"
400	G 1"	G 1 1/4"	57.0	18.0	26.5	55	B	GRI-1"-wd x 1 1/4"
400	G 1"	G 3/4"	47.0	18.0	22.0	41	B	GRI-1"-wd x 3/4"
315	G 1 1/4"	G 1 1/2"	60.0	20.0	28.5	60	B	GRI-1 1/4"-wd x 1 1/2"
400	G 1 1/4"	G 1"	52.0	20.0	24.5	50	B	GRI-1 1/4"-wd x 1"
315	G 1 1/2"	G 1 1/4"	58.0	22.0	26.5	55	B	GRI-1 1/2"-wd x 1 1/4"