

24° female and Viton O-ring
with a profile to W DIN 3861
BSP parallel male thread with
Viton elastomeric soft seal

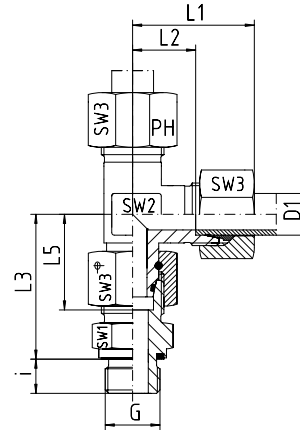

Series	Pressure PN	Tube O.D. D1	Thread G	Approx. Dimensions								Part code
				L1	L2	L3	L5	i	SW1	SW2	SW3	
L	500	6	G 1/8"	27	12.0	34.5	26.0	8	14	12	14	EL-DKOL-06-G 1/8"-wd
L	500	8	G 1/4"	29	14.0	37.5	27.5	12	19	12	17	EL-DKOL-08-G 1/4"-wd
L	500	10	G 1/4"	30	15.0	40.0	29.0	12	19	14	19	EL-DKOL-10-G 1/4"-wd
L	400	12	G 3/8"	32	17.0	42.0	29.5	12	22	17	22	EL-DKOL-12-G 3/8"-wd
L	400	15	G 1/2"	36	21.0	46.5	32.5	14	27	19	27	EL-DKOL-15-G 1/2"-wd
L	400	18	G 1/2"	40	23.5	50.0	35.5	14	27	24	32	EL-DKOL-18-G 1/2"-wd
L	250	22	G 3/4"	44	27.5	55.0	38.5	16	32	27	36	EL-DKOL-22-G 3/4"-wd
L	250	28	G 1"	47	30.5	59.0	41.5	18	41	36	41	EL-DKOL-28-G 1"-wd
L	250	35	G 1 1/4"	56	34.5	68.5	51.0	20	50	41	50	EL-DKOL-35-G 1 1/4"-wd
L	250	42	G 1 1/2"	63	40.0	75.0	56.0	22	55	50	60	EL-DKOL-42-G 1 1/2"-wd

Series	Pressure PN	Tube O.D. D1	Thread G	Approx. Dimensions								Part code
				L1	L2	L3	L5	i	SW1	SW2	SW3	
S	800	6	G 1/4"	31	16.0	40.0	27.0	12	19	12	17	EL-DKOS-06-G 1/4"-wd
S	800	8	G 1/4"	32	17.0	42.5	27.5	12	19	14	19	EL-DKOS-08-G 1/4"-wd
S	800	10	G 3/8"	34	17.5	45.0	30.0	12	22	17	22	EL-DKOS-10-G 3/8"-wd
S	630	12	G 3/8"	38	21.5	48.0	31.0	12	22	17	24	EL-DKOS-12-G 3/8"-wd
S	630	14	G 1/2"	40	22.0	54.0	35.0	14	27	19	27	EL-DKOS-14-G 1/2"-wd
S	630	16	G 1/2"	43	24.5	55.0	36.5	14	27	24	30	EL-DKOS-16-G 1/2"-wd
S	420	20	G 3/4"	48	26.5	65.0	44.5	16	32	27	36	EL-DKOS-20-G 3/4"-wd
S	420	25	G 1"	54	30.0	73.0	50.0	18	41	36	46	EL-DKOS-25-G 1"-wd
S	420	30	G 1 1/4"	62	35.5	78.5	55.0	20	50	41	50	EL-DKOS-30-G 1 1/4"-wd
S	420	38	G 1 1/2"	72	41.0	89.0	63.0	22	55	50	60	EL-DKOS-38-G 1 1/2"-wd